









LOT 16

Floor area: 106.2m<sup>2</sup>

Site area: 215m<sup>2</sup>

LOT 17

Floor area: 106.2m<sup>2</sup>

Site area: 203m<sup>2</sup>









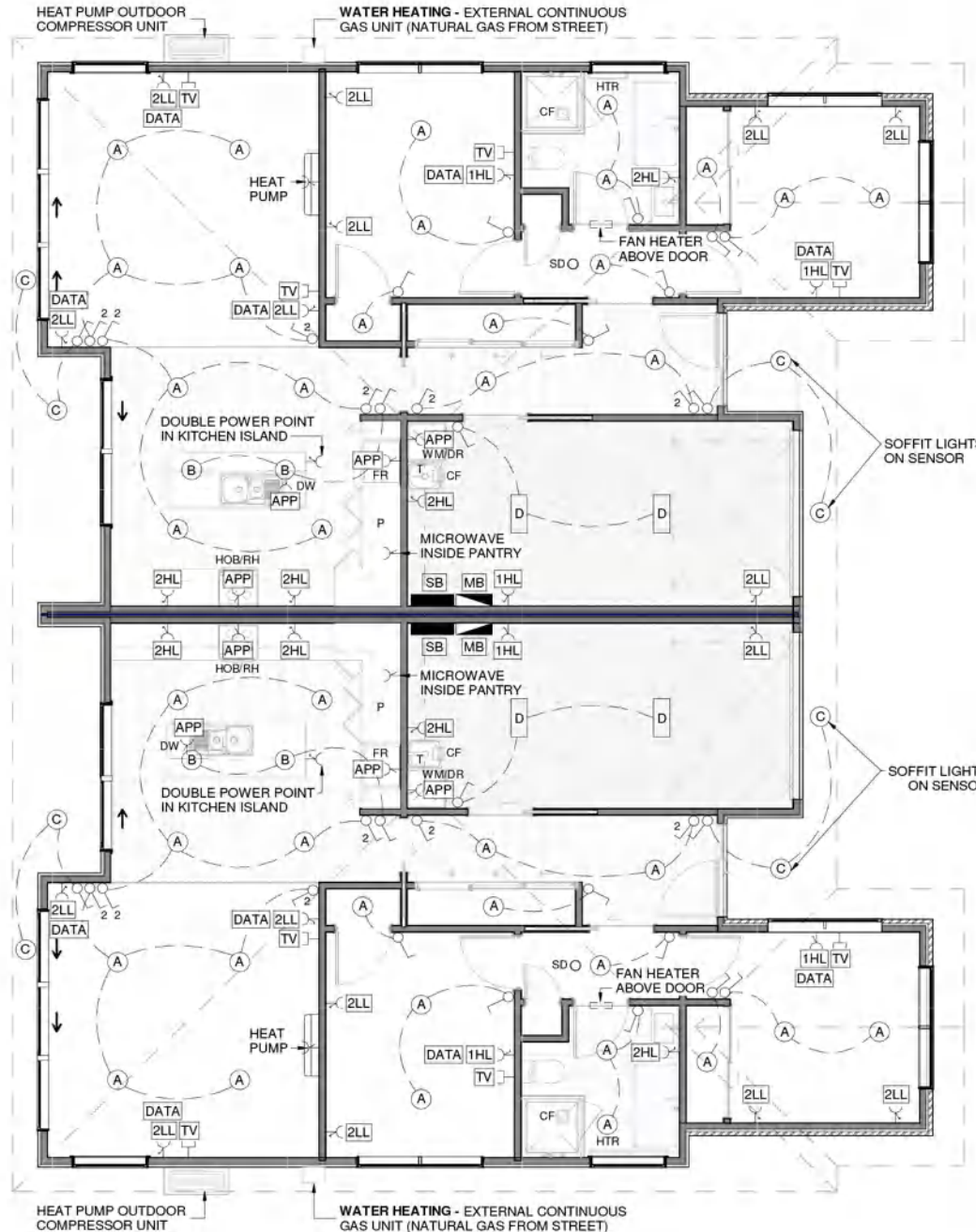

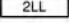
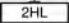

Primary wall cladding: Brick veneer (stretcher bond)

Feature wall cladding: Painted horizontal bevelback weatherboards (mitred corners with soakers)



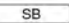

Roof cladding: Trapezoidal profile



**LEGEND - ELECTRICAL**

-  DOUBLE POWER SOCKET - LOW LEVEL (LL) 440 AFFL
-  DOUBLE POWER SOCKET - HIGH LEVEL (HL) 1200 AFFL
-  SINGLE POWER SOCKET - HIGH LEVEL (HL) 1200 AFFL
-  APPLIANCE POWER SOCKET
-  TV AERIAL OUTLETS
-  DATA / TELEPHONE OUTLETS
-  LIGHT SWITCH - 1 WAY
-  LIGHT SWITCH - 2 WAY
-  SMOKE DETECTOR - 1/ HARD WIRED DETECTOR WITHIN 3 METERS OF ALL BEDROOM DOORS
-  CEILING EXTRACTOR FAN - ON BATHROOM AND LAUNDRY  
\*WEISS FV110 IN-LINE EXTRACTOR FAN ON TIMER SWITCH DUCTED TO SOFFIT WITH 150mm DIA FLEXIBLE DUCTING
-  SWITCH BOARD / DATA HUB  
\*FIBRE FROM DATA HUB TO OUTSIDE CONNECTION POINT
-  METER BOX  
\*SMART METER (DOESN'T NEED TO BE OUTSIDE)

**LEGEND - LIGHTING**

-  RECESSED LED DOWNLIGHT - TYPE IC RATED  
\* INSULATION CAN BE INSTALLED OVER THE TOP OF THE RECESSED LUMINAIRE
-  PENDANT LED LIGHTS - REFER TO CLIENT SPEC. FOR SELECTIONS
-  EXTERIOR LIGHT SOFFIT MOUNTED
-  LED BATTEN LIGHTS FOR GARAGE



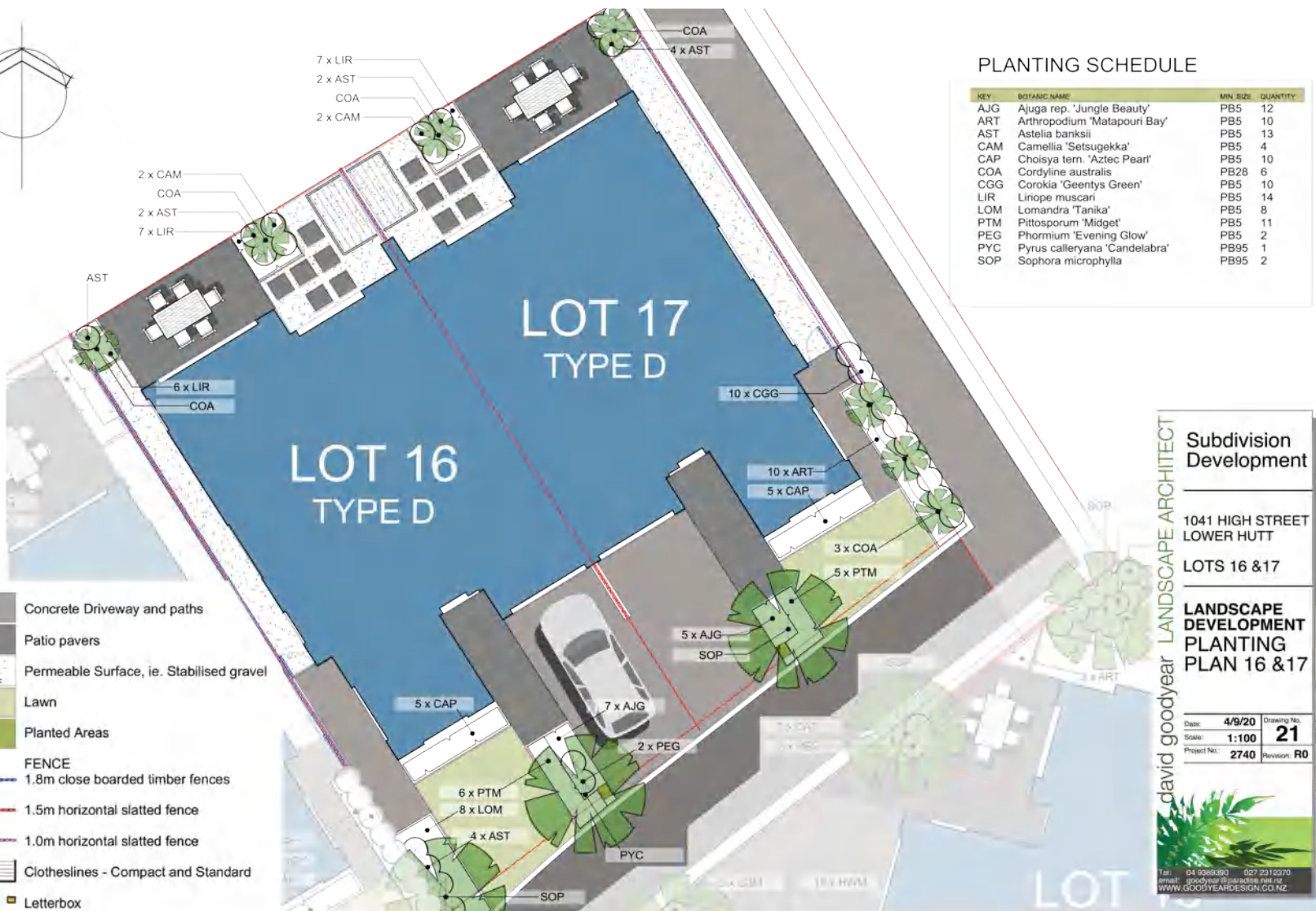

Subdivision Development

1041 HIGH STREET  
LOWER HUTT

LOTS 16 & 17

LANDSCAPE DEVELOPMENT  
PLANTING PLAN 16 & 17

David goodyear LANDSCAPE ARCHITECT

Date: 4/9/20 Drawing No: 21  
Scale: 1:100  
Project No: 2740 Revision: R0

Tel: 04 9089090 027 2312070  
Email: goodyear@landscapemasters.co.nz  
WWW.GOODYEARDESIGN.CO.NZ